

*More than ever the
comfort-first caravan*

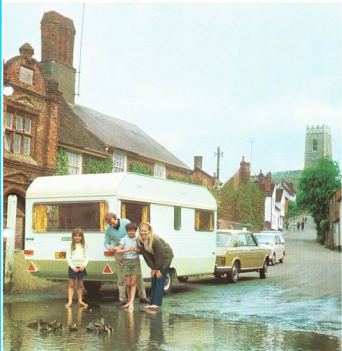

EUROPA '72

Compare it. Every time you'll put Europa comfort... first

A caravan range that really cares about your family. That sets out to study the whole family's happiness on holiday. And comes up with a whole new set of standards to match. This is Europa. Those considerations were the target Caravans International designers kept their eye on when they introduced the Europa range last year. Here was a concept that called for putting **comfort** first. And that's just what they did—designed the Europa range of Comfort First Caravans.

Awnings

Colourful awnings for all Europa models can be obtained from your C.I. Dealer or write direct to O.B.I. Caravans Ltd., Dyche St., Rochdale Road, Manchester 4 (another partner in Caravans International). The awning channel is standard on all models.



And the 1972 Europa takes comfort to new extremes. For, both outside and inside, fresh features combine to enhance the elegant look and fabulous feeling that is Europa. Features like the '72-new two-tone exterior, the special stable-type door, the lower window line with tinted acrylic fixed frost window to cut glare. The rear and side windows are all opening for greater comfort. And like, on the inside, the new colour schemes, accent on light day-and-night, the added touches of comfort in every compartment from saloon to kitchen to toilet.



Here is a caravan truly fitted for its role. Designed to be a haven of home comforts when you're in strange, faraway places, or that old favourite caravanning spot you love so well. So ambitiously minded, it had to be exceptionally able-bodied; spacious yet compact; loaded with features yet light to tow; elegantly styled yet resiliently tough. But that's only the beginning. Now take a look at all the Europa models described in the separate leaflets enclosed. For one of these Comfort First Caravans is going to come First with your Family . . .



EUROCAMPER



EUROCAMPER

A lightweight, extremely roomy nine foot six tourer that accommodates three or four people. That's the Eurocamper—Europa style caravanning for mini-car owners or for people who like an exceptionally light, easy-to-tow caravan that is quality-built. Generous cupboard and storage space. Vinyl covered floor. Double dinette. Ample, modern cooking facilities. A really sparkling tourer at a price that is exceptionally economical.



comfort-first caravans

Europa Caravans The Oaks, Fordham Road, Newmarket.



These specifications details do not apply to any particular version which is supplied or offered for sale. The manufacturer reserves the right to vary their specifications with or without notice and at such times and in such manner as they may in their sole discretion see fit. Therefore, although every effort is made to ensure the accuracy of the particulars contained in this brochure, neither the company nor the dealer, to whom the publication is issued, shall be liable for any inaccuracy in any circumstances whatsoever. Consult the dealer with whom your order is placed for details of the specifications of any particular vehicle. This publication shall not constitute in any circumstances whatsoever an offer by the Company in any country.



Floor Plan Key

- A** Day seat/single berth with storage space under
- B** Day seat/double berth with storage space under
- D** Foldaway bunk over—optional extra
- E** Sink unit with storage space above and below
- F** Twin burner hotplate grill with storage space above and below
- M** Shelf
- T** Table
- ⚡** Gas light
- Wardrobe space
- Total sleeping area

Here are the optional extras for you to select when ordering:—

- Foldaway bunk
- Foot pump and fender.

EUROCAMPER

A four-seater dinette that converts at night to a roomy double bed, provides Europa standards for small car enthusiasts. There's a third berth and an optional fourth. There's also a wardrobe and a kitchen unit—that's comfort at an economical price. Let's take a closer look at that kitchen. Twin burner hotplate and

grill. Sink unit. Cupboards and drawers with a roof light over so you can see what you're doing. The Eurocamper is fully-equipped for touring and, in the 9' 3" range, you'd have difficulty in finding anything anywhere near comparable—in comfort, design or value.

Look what you get in a Eurocamper—roof lockers to give that extra bit of storage space, wide-opening windows to give even more air and light. You also get a roof light to throw light into the interior and let warm air or cooking smells out and, at night-time, you have the cosy glow of gas lighting.



EUROPA 325



EUROPA 325 4 BERTH

Fabulous comfort for the family of four. Everything about this 11 footer reflects the care that has gone into its design. The two-tone exterior is more than just tastefully elegant, its front lower panel is stuccoed to act as a stone guard. At the front the latest tinted acrylic window is fitted, the expensive look with the protective feel for sun-surrounded eyes. Inside, the 325, makes the whole family comfortable. The new colour scheme, large roof light and extra window panoramas from the kitchen make for bright days whatever the weather. Fluorescent and gas lighting, sumptuous seating and sleeping ensure cosy evenings and nights. The stainless steel sink and hot plate and grill are designed with you, the caravaner, in mind. And when you want to relax, you'll bless the spacious comfort all around, applaud the new shelves over the windows for out-of-the-way storage. Truly, Europa comfort is in a class by itself.



*comfort-first
caravans*

Europa Caravans

The Oaks, Fordham Road, Newmarket.



These specification details do not apply to any particular caravan which is quoted or offered for sale. The manufacturers reserve the right to vary their specifications with or without notice and in such manner as they think fit. Buyers do well to make changes they may require. Therefore, although every effort is made to ensure the accuracy of the particulars contained in this brochure, neither the company nor the dealer, by whom this publication is issued, shall be liable for any inaccuracy in any circumstances whatsoever. Contact the dealer with whom you order or place for details of the specifications of any particular vehicle. This publication shall not constitute in any circumstances whatsoever an offer by the Company to any person.

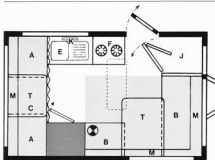

Floor Plan Key

- A Day seat/single berth with storage space under
- B Day seat/double berth with storage space under
- C Foldaway bunk over
- E Sink unit with storage space above and below
- F Twin burner hotplate grill with storage space above and below
- J Toilet compartment
- K Fluorescent light
- M Shelf
- T Table
- ⚡ Gas light
- ~ Dividing curtain
- Wardrobe space
- Total sleeping area

Here are the optional extras for you to select when ordering:—

- | | |
|------------------------|----------------|
| Car Heater | Foldaway Bunks |
| 2 cu. ft. Refrigerator | Double Glazing |
| Underfloor Insulation | |
| Full oven cooker | |

EUROPA 325

There's plenty of room inside the 325. Two dormers still leave plenty of floor space. Extra long beds, and good headroom add to the spacious feel of this handsome 11-footer. And there's still room for the wardrobe and toilet compartment.

Fitting in with the Europa's lower window line is a new stable-type door. You can close the lower half and leave the top open to provide maximum fresh air and light.

Just another comfort touch you get with the Europa 325—is fluorescent light. This is in addition to the standard gas light fitting and ensures your caravan has plenty of light at all times.



EUROPA 390



EUROPA 390 4 BERTH

The masterpiece that makes Comfort as flexible as it is fabulous. This roomy 13 footer offers a really well designed, accent-on-comfort 4-berth layout.

Whichever you choose, you enjoy the utmost in caravan comfort. Europa super amenities, like the new stable door with window, the separate toilet compartment with the wash-in-comfort difference (it's almost like a private bathroom!). The footpump and faucet are a convenient complement to the stainless steel sink. Europa's hook-on tables are heat resistant, child proof—designed to make mealtime or playtime a pleasure. Shelves and cupboards are a Europa speciality that help to create that uniquely spacious feeling. Lighting leaves nothing to be desired and, with both fluorescent and gas, nothing to chance. (Even the gas bottle cover is comfortably in line with Europa design care). From the dinette (6' 3" loungeseats by day, blissful beds by night) to the dream kitchen with twin hotplate and grill, easy-clean work tops, etc., comfort comes first with the Europa 390.



*comfort-first
caravans*

Europa Caravans

The Oaks, Fordham Road, Newmarket.



These specification details do not apply to any particular caravan which is supplied or offered for sale. The manufacturer reserves the right to vary these specifications with or without notice and it shall remain good to each caravan as they think fit. Weight as well as minor changes may be required. Therefore, although every effort is made to ensure the accuracy of the particulars contained in this brochure, neither the company nor the Dealer, for whom this publication is issued, shall be liable for any inaccuracies in any circumstances whatsoever. Consult the Dealer with whom your order is placed for details of the specifications of any particular vehicle. This publication shall not constitute in any circumstances whatsoever an offer to the Company to any person.

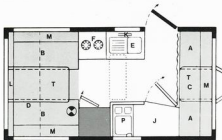

Floor Plan Key

- A** Day seat/single berth with storage space under
 - B** Day seat/double berth with storage space under
 - C** Foldaway bunk over
 - D** Foldaway bunk over—optional extra
 - E** Sink unit with storage space above and below
 - F** Twin burner hotplate grill with storage space above and below
 - J** Toilet/shower compartment
 - K** Fluorescent light
 - L** Roof locker
 - M** Shelf
 - P** Washbasin/Mirror
 - T** Table
 - Z** Gas light
- ~ Dividing curtain
 □ Wardrobe space
 □ Total sleeping area

Here are the optional extras for you to select when ordering:—

- Gas Heater
- Foldaway Bunks
- 2 cu. ft. Refrigerator
- Shower Unit
- Wet/dry Insulation
- Double Glazing
- Full oven/cooker

EUROPA 390

With a double dinette at one end and a two-seater dinette at the other the superb Europa 390 still has plenty of space in the middle, plus a toilet that's bigger than you'll find on most caravans—all superbly equipped for comfort lovers.

And notice the kitchen unit in which can be fitted an optional extra refrigerator. If you want room to move in, 4 berth comfort, choose the spacious Europa 390.

And the Europa 390 scores on light, too. There are no less than six windows, a large handsome roof light and if that's not enough you can swing back the top half of the door. There's a light airy feeling that's pleasant to live with all summer through. And at night you have both gas and fluorescent lighting systems.



EUROPA 455



EUROPA 455 5/6 BERTH

Comfort doesn't come any more generously than this. You enjoy all the things that put Europa caravanning comfortably ahead. The good looking two-tone exterior, the streamlined easy-access gas bottle cover. Open the new, stable-type door or look through the plentiful window area, and you've got the inside story on exclusive Europa comfort. Behind those windows (the front one's tinted to soothe away glare) there's the beautifully-planned 1972 layout.

With the toilet at the front, the 455F becomes the most fabulously comfortable five-berther ever: providing two single beds at the rear, bunk above, and a double bed at the front. The same imaginative thinking enables Europa to fit in so many comforts—the separate wash-room with elegant hand basin and mirror, (in 455C only) the cupboards, shelves, tables, the full oven cooker—yet leaves so much spacious comfort. If you're looking for a really superb 5 berth number, the 455 is for you.

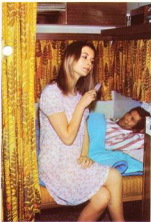

*comfort-first
caravans*

Europa Caravans

The Oaks, Fordham Road, Newmarket.

New as '72 . . . yet already proved

Take a new look . . . The caravan that took the trans Europe Monte Carlo Rally route so comfortably in its stride last year . . . the range that proved a Concept worthwhile . . . even better for 1972.



Look how snugly the optional extra fridge fits into the kitchen unit (not available for the Eurocamper).



This shower unit can be fitted as an optional extra in the 290 and 455c models.

The 1972 Europa Range

DIMENSIONS	Eurocamper		Europa 325		Europa 390		Europa 455	
Body Length	2842 mm	9' 3½"	3335 mm	10' 11½"	3070 mm	13' 0½"	4605 mm	15' 1½"
Overall Length	3723 mm	12' 2½"	4377 mm	14' 4½"	5012 mm	16' 5½"	5647 mm	18' 6½"
Overall Width	1955 mm	6' 5"	2021 mm	6' 7½"	2021 mm	6' 7½"	2021 mm	6' 7½"
Overall Height	2375 mm	7' 9½"	2394 mm	7' 10½"	2394 mm	7' 10½"	2394 mm	7' 10½"
Maximum headroom	1860 mm	6' 1½"	1848 mm	6' 0½"	1848 mm	6' 0½"	1848 mm	6' 0½"
*Weight ex-works — or —5% in standard trim	432 kgs	8½ cwt	584 kgs	11½ cwt	649 kgs	12½ cwt	725 kgs	14½ cwt
Maximum all-up weight	584 kgs	11½ cwt	745 kgs	14½ cwt	851 kgs	16½ cwt	955 kgs	19 cwt
CHASSIS	All steel frame welded, independent suspension and damper units							
Brakes (Drum)	8" Girling		8" Lockheed		8" Lockheed		9" Girling	
Tires	5.20 x 13		5.60 x 13		5.90 x 13		6.40 x 13	
Wheels	3.500 x 13 4 stud		3.500 x 13 4 stud		4½ x 13 4 stud		4½ x 13 4 stud	
Coupling	50 mm Spring damped				50 mm Hydraulic			
Legs	Four		Four		Four		Four	
Body	Timber framed body with hardboard interior and aluminium exterior panelling. Roof and walls insulated with glass fibre							
Opening windows	All open		All open except front		All open except front		All open except front	
Adjustable roof lights	One		One		One		One	

*Figures given are for standard ex-works U.K. model specification. Weight allowance should take into consideration personal effects, gas bottles and accessories. Also factory fitted optional extras, i.e. heater, refrigerator, etc.



These specification details do not apply to any particular caravan which is supplied or offered for sale. The manufacturer reserves the right to vary their specifications with or without notice and in such cases and in such manner as they think fit. Major as well as minor changes may be necessary. Therefore, although every effort is made to ensure the accuracy of the particulars contained in this brochure, neither the company nor the Dealer, by whom this publication is issued, shall be liable for any inaccuracy in any circumstances whatsoever. Consult the Dealer with whom your order is placed for details of the specification of any particular vehicle. This publication shall not constitute in any circumstances whatsoever an offer by the Company to any person.

Europa Caravans, The Oaks, Fordham Road, Newmarket.
 Proprietors: C.V. Towing Caravans Ltd. Produced by Stoberham Advertising Ltd. 35117/8/72